

## Flood Light Kit Assembling Steps:

**Option 1:** To attach the stake, use the included screw and washer. Align the hole on the stake to the hole on the flood light housing. Slide the screw through the hole and turn the fastener clockwise until tight.

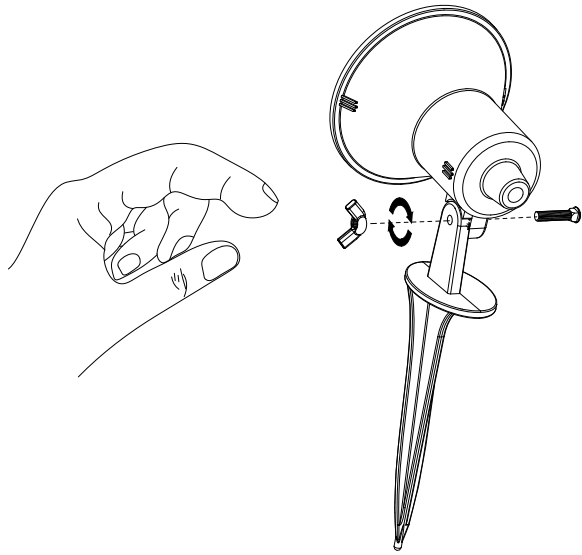

**Option 2:** To attach the wall mount base, use the included screw and washer. Align the hole on the stake to the hole on the flood light housing. Slide the screw through the hole and turn the fastener clockwise until tight. (This option requires extra screws to be installed onto the wall/siding of your choice. A power drill is required for this option.)

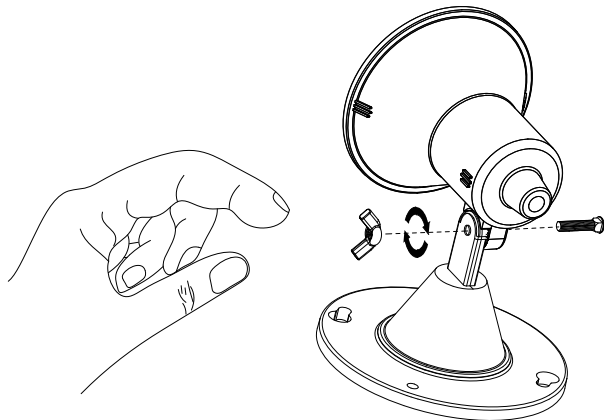

## Box Contents

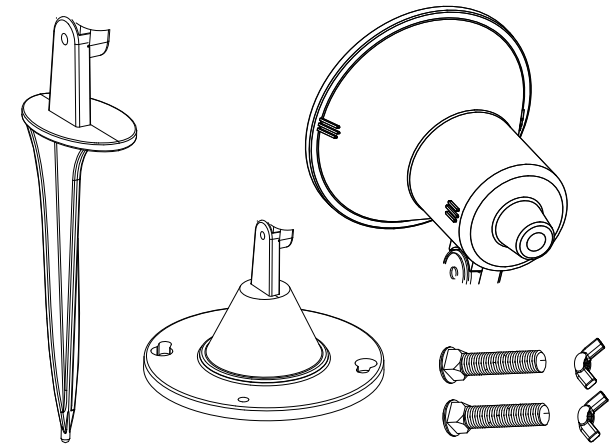

(1) Flood Light Housing (bulb not included)

(1) Attachment Stake

(2) Screw and fastener set

**Mount Install:** Using a power drill, drill the screws into each hole on the mount to the designated wall/siding of choice.

**Note:** Extra screws and mollys (fasteners are not included)

